

0.5", Plastic Face Plate
PEI Dome Diaphragm
Dual Ferrite Magnet Motor System
With Ferrofluid-Cooled 4000 Cps

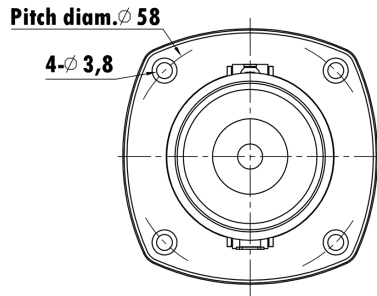
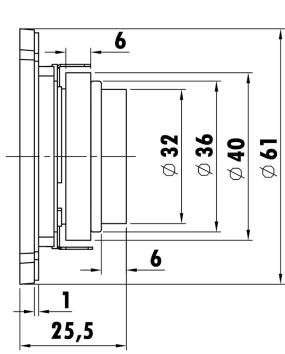

Discontinued

T-S Parameters

Resonance frequency [fs]	3436.8 Hz
Mechanical Q factor [Qms]	1.247
Electrical Q factor [Qes]	10.744
Total Q factor [Qts]	1.117
Force factor [Bl]	1.372 Tm
Mechanical resistance [Rms]	3.382 kg/s
Moving mass [Mms]	0.195 g
Compliance [Cms]	0.011 mm/N
Effective diaph. diameter [D]	25 mm
Effective piston area [Sd]	4.91 cm ²
Equivalent volume [Vas]	0.0004 l
Sensitivity (2.83V/1m)	92 dB
Ratio Bl/√Re	0.63 N/√W
Ratio fs/Qts	3077 Hz

Electrical Data

Nominal impedance [Zn]	5. Ω
Minimum impedance [Zmin]	5.076 Ω
Maximum impedance [Zo]	5.752 Ω
DC resistance [Re]	4.79 Ω
Voice coil inductance [Le]	0.026 mH

Power Handling

100h RMS noise test (IEC 17.1)	20 W
Long-term max power (IEC 17.3)	- W

Voice Coil & Magnet Data

Voice coil diameter	13.28 mm
Voice coil height	1.7 mm
Voice coil layers	2
Height of gap	2 mm
Linear excursion	± 0.15 mm
Max mech. excursion	± - mm
Unit weight	0.0975 kg

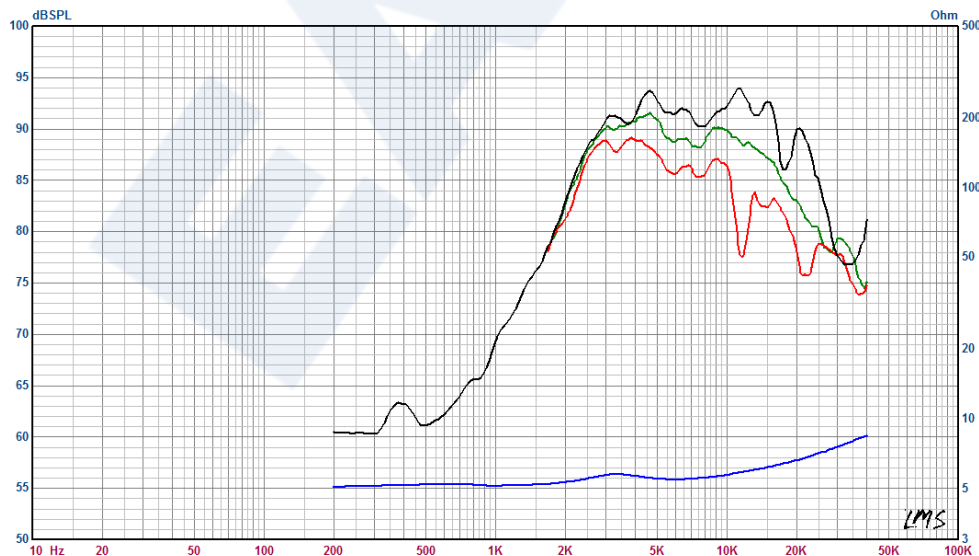

- 60° Off- axis
- 30° Off- axis
- On - axis